



Mr. First Carl Mrs./Ms. First Sue Last Richardson Historical District Yes No
 Job Address 1172 Oakwood City Napoleon Zip 43545 Main Cross Streets RT 24
 Home Phone 419 592 6412 Mr. Work None Mr. Cell (419) 439 3335 Mrs. Work None Mrs. Cell None
 Mr. Email None Mrs. Email None
 FWN: Windows Siding Trim Roofing Type of Home: House Condo MHC Story 1 2 3
 Floating Install Yes No On Vacation _____ to _____ Billing Address Same Year Home Built 1900 BEST 9 to 5 Number to Call Home
 LOCATION: Detroit Toledo Lansing Columbus Other

Page 1 of 1
 Measure Date 9-26-08
 Time 10 AM
 Install to be completed in approximately 4 to 8 weeks after approval.
 Appt. # 925507

Notice to buyer: (1) Do not sign this contract before you read it. (2) You are entitled to two completely filled in copies of this contract. (3) Under the law, you have the right to pay off in advance the full amount due and, under certain conditions, to obtain a partial refund of the finance charge. (4) You may rescind or cancel this contract, not later than 5 P.M. on the business day following the date thereof by giving written notice or rescission to the Contractor or his agent at his place of business given in the contract or by mailing the notice or cancellation to the contractor to his place of business given in the contract by depositing a properly addressed certified letter in a United States Post Office or mail box, but if you rescind 5 P.M. on the business day following, you are still entitled to offer defenses in mitigation of damages and to pursue any rights of action or defenses that arise out of the transaction. We, the Owners of the below, described premises, hereby contract with and authorize you as Contractor (Hansons' Window and Siding), to furnish all necessary materials, labor and workmanship, to install, construct and place the improvements according to the specifications, terms and conditions (including those on reverse side), on the premises described below.

Sticker Number	Location	Salesperson Measure	United Inches	Model Number	Window Type (Abbreviated)	Window Color (See Below or if different colors Specify Here)	Configuration 1/2, 2 1/2, 3, 1/3, 1/3 or St. Standard R.V. etc.	Ends Slat / BH / Castout	Number of Lifes	Needs Roof Y/N	Birch / Oak	Aluminum Grids	Heritage Grids	V-Groove Brass	Pattern Co. Dis. Mc. Minc. Frame	V-C / Ends on Ends ONLY	Decorative Glass	Furniture	Marbleite / Wood	Sill Width	White on White (W/W)	Black on White (B/W)	Brown on White (B/W)	# Mull Removals	# Mull Together	Security Bars	Alarm Contacts	Sheet Pan / Casing	New Buck	Build Up / Build In	Cut Down / Cut Side	Cut Out	Electrical Reroute	NOTES
1	LR	48x65	113	5100	SH																													
2	LR	30x65	95	5100	SH																													
3	Bed	30x65	95	5100	SH																													
4	Bed	30x65	95	5100	SH																													
5	KIT	23x46	69	5100	SH																													
6	BATH	30x61	91	5100	SH																													
7	Den	30x61	91	5100	SH																													
8	Fam	45x61	106	5100	SH																													
9	Bed	44x61	106	5100	SH																													
10	Bed	30x61	91	5100	SH																													
11	Bed	30x61	91	5100	SH																													
12	Bed	30x61	91	5100	SH																													
13																																		
14																																		
15																																		
16																																		
17																																		

ALL WINDOWS TO HAVE GLASS TYPE: Clear Low E IQ Heat Mirror
 EXTERIOR TRIM COLOR: White Cocoa Beige Other
 WINDOW COLOR: EXTERIOR White INTERIOR White
 Wood grain interiors are only available on white, beige or cocoa windows
 Half Screens Full Screens
 Existing Sills To Remain? Yes No Both (See Above)

* All windows include installation & caulk and rotted wood replacement (for installation of windows only). Includes Clean up & Haul away * 100% Money Back Guarantee (See Reverse Side for Details)
 COMMENTS: Customers would like windows installed before Oct 30-08 due to knee surgery
 Certain city building codes require smoke detectors. Hansons will provide & install for a charge of \$25.00 each.
 BUYERS RIGHT TO CANCEL: IF THIS CONTRACT WAS SOLICITED AT YOUR RESIDENCE THE HOME SOLICITATION SALES ACT PROVIDES YOU A LIMITED RIGHT TO CANCEL AS FOLLOWS - YOU THE BUYER MAY CANCEL THIS TRANSACTION AT ANY TIME PRIOR TO MIDNIGHT OF THE THIRD BUSINESS DAY AFTER THE DATE OF THIS TRANSACTION. SEE THE ATTACHED NOTICE OF CANCELLATION FORM FOR AN EXPLANATION OF THIS RIGHT.
 For the total cash price of \$ 5575.00
 Buyers down payment amount of (50% Deposit Req.) \$ 1840.00
 Cash to be paid upon Substantial completion \$ 3735.00
 Amt. to be financed by financial Co. upon substantial completion \$ -0-
 Down Payment and/or Final Payment in form of: Cash Check Visa Mastercard Discover 5687
 Credit card in the name of: _____
 Credit card account #: _____
 Exp. Date: _____
 3 or 4 Digit CPU Code: _____

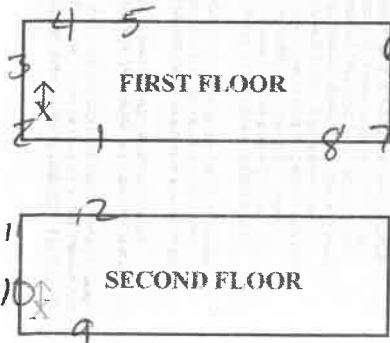

SIGN POSTED 90 DAYS.
 * Lifetime Plus Guarantee (See Reverse Side for Details)
 IN WITNESS WHEREOF the parties have here unto signed their name(s) this 24 day of Sept 2008
 Michigan (Ohio) HOME SOLICITATION SALES ACT* rescission cut off date: 29 day of SEPT 2008
 Owner: Angemett Richardson
 Witness by Salesperson: [Signature]
 Customer agrees to pay for all building permit costs (See back of Contract, Paragraph 9, Section C). [Signature]

Here are the names of Friends or Family I'd like to refer.
 Name _____
 Telephone _____
 Friend Relative Neighbor
 Name _____
 Telephone _____
 Friend Relative Neighbor
 I/we hereby acknowledge receipt of a copy of the pamphlet, "Protect Your Family From Lead In Your Home", informing me/us of the potential risk of lead hazard exposure from renovation activity to be performed in my/our home. I/we received this pamphlet before the work began.
 CUSTOMER INITIALS [Signature] Int. _____